

# Yonder Prairie 26 Acres

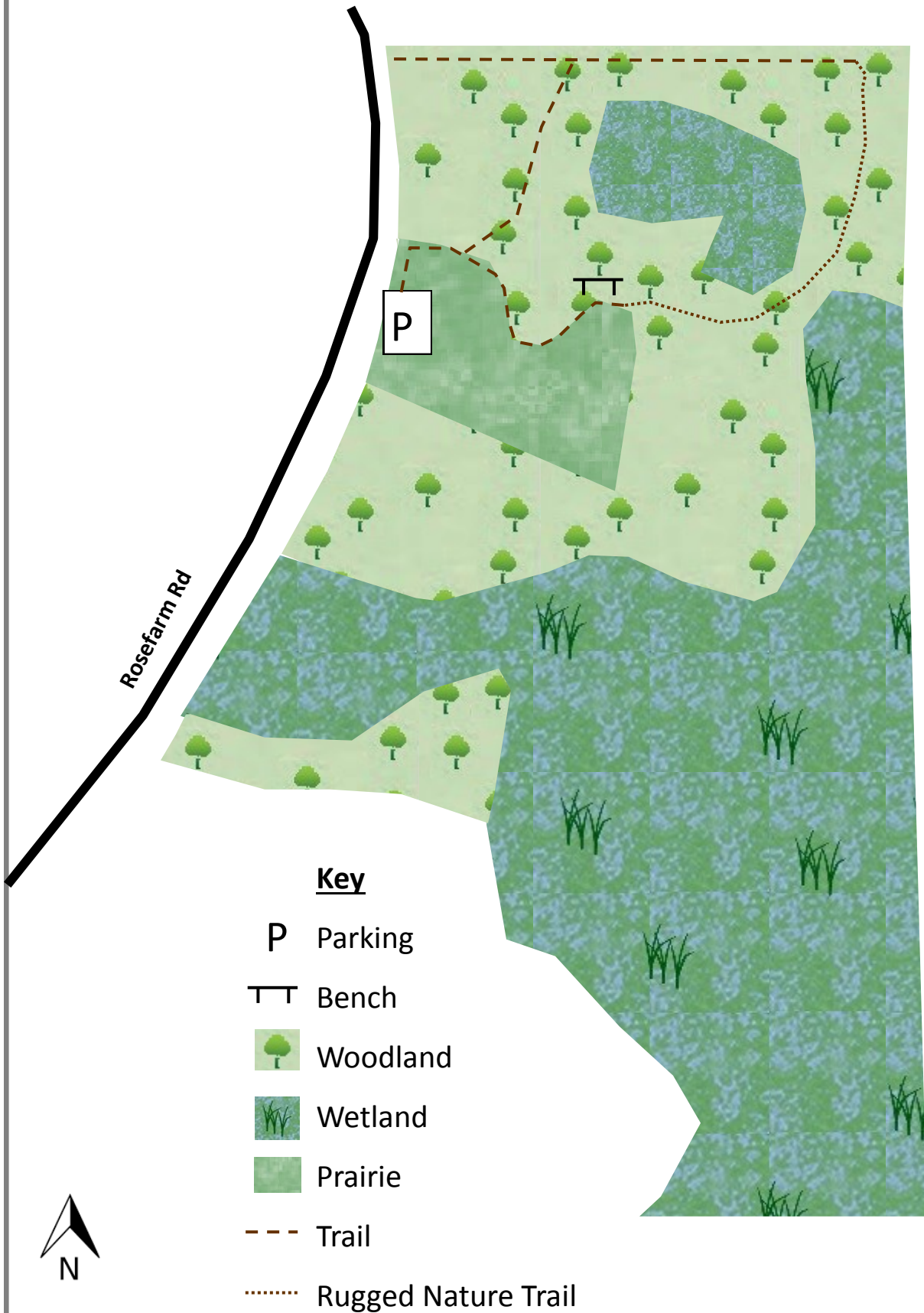

## SITE LOCATION

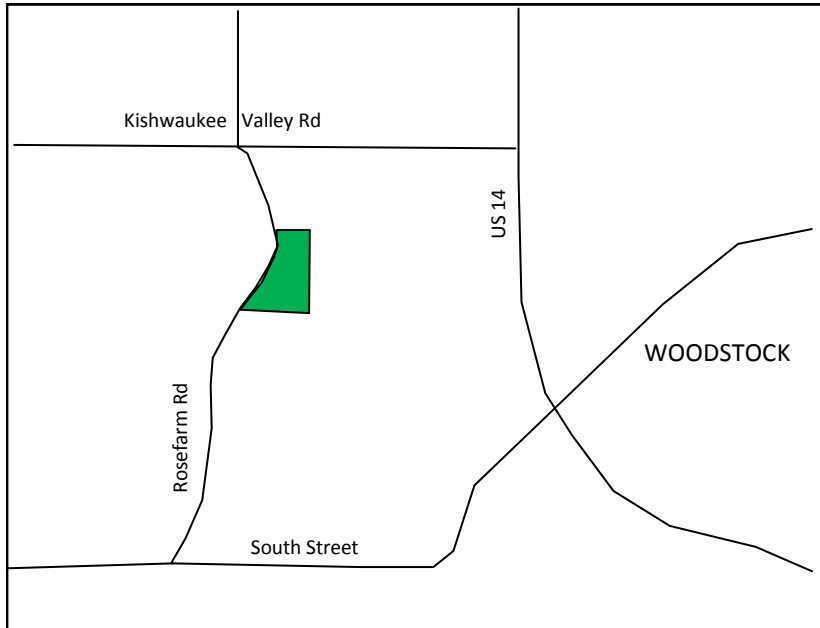

## GENERAL RULES

**Site hours are sunrise to sunset.**

**No alcohol.**

**Pets must be leashed at all times.**

**No camping.**

**No fires.**

**No removal or disturbance of any plant or animal life.**

## INFO AND HISTORY ABOUT SITE

**This park is part of a much larger natural wetland complex covering approximately 260 acres and consisting of a mosaic of prairies, wetlands, and oak savannas. Yonder Prairie has a rich diversity of plant species and habitats that support local populations of wildlife, including several state-threatened species. This is one of the newest sites The Land Conservancy has acquired, and it is currently being restored to a healthy ecosystem by removing nonnative invasive weeds and shrubs and by seeding native plants. Volunteer workdays take place here every 2nd Saturday of the month from 9-12.**



[www.ConserveMC.org](http://www.ConserveMC.org)